

HK75A4

Halo Style Anchor Base LED Pole Kit with 75 Watt LED and 4 Inch Diameter Round Pole



Job: _____
 Job Site: _____ State: _____ Client Name: _____
 Notes: _____ Approvals: _____ Date: _____

Commercial-grade LED Light Pole Assembly Includes:

4 OD Aluminum light pole, Architectural style 75 Watt LED light and Mounting hardware.

Light Pole:

Pole Shaft: 4 inch round straight aluminum with 0.125" wall thickness.

Seamlessly extruded from 6063-T6 alloy.

Pole Height: Standard above grade pole height is 16 ft. Optional heights are 14, 12, 10 and 8 ft.

Custom heights are also available.

Handhole: 2-1/2" X 4" size handhole is located at 18" from the ground line.

An aluminum handhole cover with 2 screws is provided.

A ground lug with set screw is located near the handhole opening for proper grounding of the pole.

Anchor Bolts: A set of 4 galvanized steel anchor bolts is provided with each pole assembly.

Each anchor bolt includes 2 nuts and 2 washers. Top portion of the anchor bolt is threaded for securing and leveling the pole with the provided nuts and washers.

An actual size paper anchor bolt template is provided.

Color: Black powder coat.

Base Cover: ABS Plastic base cover with rivets.

LED Fixture:

Material: Aluminum construction.

Light Distribution: Type V

Color: Black powder coat.

Power: 75 Watts

Lumens: 9,600

Lumens/Watt: 128

Voltage: 120-277 Volt standard. 345-480 Volt option as special order.

Adjustable Color Temperature:

3000K/4000K/5000K

Shorting Cap: Shorting Cap(Standard).

Twist-Lock photocell (Optional).

Dimmable: Yes. (Control is not included).

UL Listing: UL Listed for Wet Locations.

DLC Listing: DLC Premium.

IP Rating: IP65

Life Expectancy: 50,000 hours

Warranty: 5 Years.

Weight: 15 lbs.

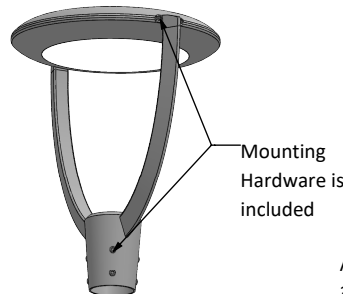
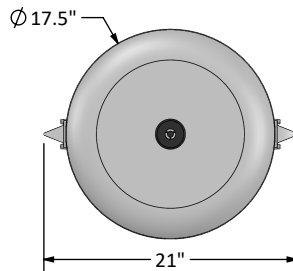
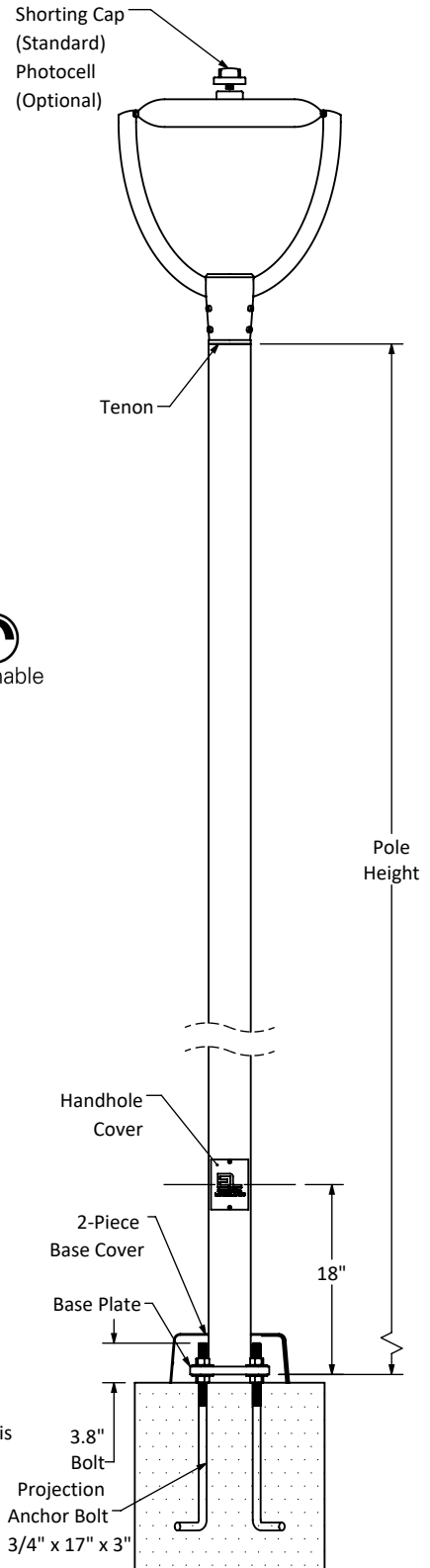

Total Power (Watts)	Total Lumens	Total Amps	
		120V	277V
75	9,600	0.63	0.27

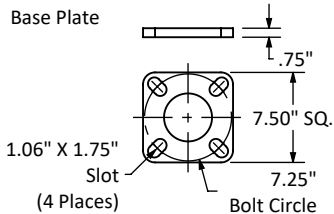

Disclaimer: All dimensions and specifications are subject to change without any notice. Light Pole Foundation should be designed by an engineer familiar with local soil and wind conditions as well as local code where the light pole will be installed.